

- NOTES
- HATCH INDICATES 2 HR WALL ASSEMBLY
 - PROVIDE 1 1/2" Ø MD HANDRAIL @ 36" A.F.I. (TYP.)
 - PROVIDE TEMPERED SAFETY GLAZING PER SRC R308 IN ALL DOORS (TYP.)
 - 1 HOUR PARTY WALLS (MIN. STC = 59) TYP.
 - HATCH REPRESENTS UNDERSIDE OF EXPOSED FLOOR JOIST ASSEMBLY & SHALL BE PROTECTED WITH 1HR FIRE RATED ASSEMBLY PER TABLE R302.1.
 - 1HR RATED HORIZONTAL SEE DETAIL 8/A7.
 - MIN. 1/2" G.B.B. REQUIRED AT THE ENCLOSED & ACCESSIBLE UNDERSTAR SPACE (ALL WALLS, SOFFITS AND UNDERSTAR SURFACES IN THE ENCLOSED AND ACCESSIBLE SPACE).
 - WSEC 2015 PRESCRIPTIVE ENERGY CODE COMPLIANCE
 - SMALL DWELLING UNIT (LESS THAN 1500 FT²): 1.5 CREDITS REQUIRED
 - WSEC R406.2 - OPTION 5C - 1.5 ENERGY CREDIT
 - WATER HEATING SYSTEM SHALL INCLUDE (ELEC WATER HEATER WITH MINIMUM EF OF 0.91)
 - PROVIDE - RINNAL RURDI (REU-RB25,30FFUD-US)
 - NATURAL GAS FIRED TANKLESS WATER HEATER WITH 0.96 EF.
 - TOTAL: OPTION 5C 1.5 CREDITS = 1.5 REQUIRED CREDITS

FIRST FLOOR PLAN
 SCALE: 1/4" = 1'-0"
 NOTES:
 WALL TYPES SEE A2.3
 DOOR SCHEDULE SEE A2.3

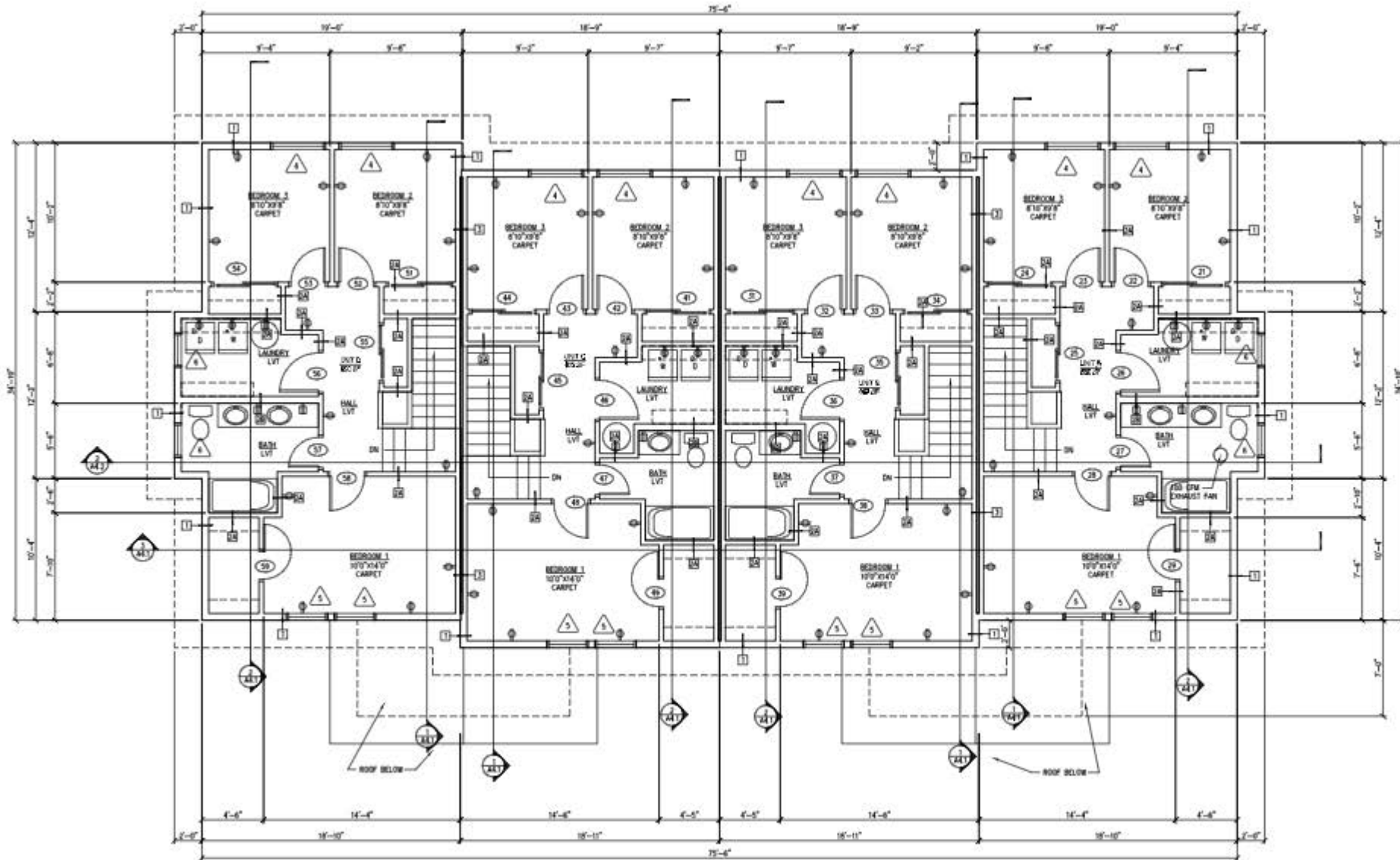

ELECTRICAL LEGEND			
(SOME SYMBOLS MAY NOT BE USED ON DRAWINGS)			
SYMBOL	DESCRIPTION		
⊠	DUPLEX RECEPTACLE (NEMA 5-20R)		
⊠	GFCI DUPLEX RECEPTACLE (NEMA 5-20R)		
⊠	SUBSCRIPT: REF REFRIGERATOR		
⊠	⊠	DW DISHWASHER	
⊠	⊠	⊠	WEATHERPROOF
⊠	⊠	⊠	ASTERISK INDICATES COUNTER HEIGHT OUTLET (DUPLEX RECEPTACLE SHOWN)
⊠	⊠	⊠	RANGE RECEPTACLE (NEMA 14-50R)
⊠	⊠	⊠	DRYER RECEPTACLE (NEMA 14-30R)
⊠	⊠	⊠	FURNACE RECEPTACLE (PER MFG)
⊠	⊠	⊠	WATER HEATER RECEPTACLE (NEMA 0CS)
⊠	⊠	⊠	MOTOR CONNECTION
⊠	⊠	⊠	PANELBOARD
⊠	⊠	⊠	SMOKE DETECTOR
⊠	⊠	⊠	SMOKE DETECTOR/CARBON MONOXIDE DETECTOR

- ELECTRICAL NOTES**
1. ELECTRICAL WORK IS BIDDER DESIGNED. KEY OUTLETS AND ELECTRICAL DEVICES ARE SHOWN. OTHER OUTLETS AND DEVICES AS REQUIRED BY CODE SHALL BE INSTALLED.
 2. ELECTRICAL PANEL LOCATION IS SHOWN IN EACH UNIT. INSTALL PANELS FLUSH WITH WALL.
 3. ALL BATHROOM, KITCHEN AND CRAWL SPACE OUTLETS SHALL BE GFCI.
 4. ALL JUNCTION BOXES AND ELECTRICAL DEVICES BELOW FIRST FLOOR AND IN CRAWL SPACE SHALL BE RATED FOR WET LOCATIONS.
 5. ALL ELECTRICAL DEVICES SHALL CONFORM TO HANDBOOK FOR HUMANITY STANDARD SPECIFICATIONS INCLUDING MANUFACTURER AND MODEL NUMBER.
 6. ALL ELECTRICAL IN FIRE ASSEMBLIES SHALL NOT BE LOCATED BACK TO BACK IN THE SAME STUD SPACE.
 7. ALL WALLS THAT HAVE FIRE OR ACoustICAL REQUIREMENTS SHALL HAVE ALL CONCEALED ELECTRICAL BONES BE WRAPPED IN ACoustICAL / FIRE PUTTY PADS.
 8. PANEL BOARD & BREAKERS - SIZES 3 PER MFG OR PROGRAM.
 9. JUNCTION BOXES - AIR TIGHT ALL LOCATIONS PER MFG.
 10. ALL EXPOSED ELECTRICAL DEVICES & COVERS TO BE WHITE.

- WALL TYPES SEE A2.3**
1. EXTERIOR WALL: 2x4 WOOD STUDS @ 16" OC CENTER WITH GIBBON OVER VAPOR BARRIER AND R-21 BLANKET INSULATION. FROM FLOOR TO ROOF DECK. COVER INSULATION EXPOSED TO ATIC OR INTERSTITIAL SPACE WITH VAPOR BARRIER. FIBER CEMENT SIDING OVER MOISTURE BARRIER ON 1" PLYWOOD SHEATHING.
 2. 2x4 WOOD STUDS AT 16" OC WITH GIBBON BOTH SIDES. INSTALL PLYWOOD ON WOOD STUDS WHERE REQUIRED PER STRUCTURAL.
 3. 2x4 WOOD STUDS AT 16" OC WITH GIBBON BOTH SIDES. INSTALL PLYWOOD ON WOOD STUDS WHERE REQUIRED PER STRUCTURAL.
 4. 1.5" FIRE PUTTY WALL WITH DOUBLE STUD WALLS WITH 2x4 OR 2x4 STUDS AT 16" OC WITH (1) LAYERS GIBBON BOTH SIDES OVER AIR BARRIER. INSTALL PLYWOOD ON WOOD STUDS WHERE REQUIRED PER STRUCTURAL.

GENERAL NOTES

COVER ALL INSULATION EXPOSED TO ATIC ON THE HEATED SIDE WITH VAPOR BARRIER SCHEM BEFORE APPLYING THE GIBBON CEILING BOARDS.

COVER ALL INSULATION EXPOSED AT UNDERFLOOR OF LOWER FLOOR TO CRAWL SPACE WITH AIR BARRIER ATTACHED TO THE BOTTOM OF THE FLOOR JOISTS.

SEAL ALL GIBBON EDGES AND PENETRATIONS AS REQUIRED TO ENSURE ACoustICAL PERFORMANCE OF WALL.

SEAL ALL GIBBON EDGES AND PENETRATIONS AS REQUIRED TO ENSURE FIRE PERFORMANCE OF WALL AND CEILING.

AT DOUBLE LAYERS OF GIBBON OFFSET JOINTS AND SCREW (NO ADHESIVE). SEAL ALL JOINTS IN A FIRE WALL.

AT PARTY WALLS BETWEEN UNITS SEAL ALL PENETRATIONS WITH ACoustICAL AND FIRE PUTTY PADS.

SECOND FLOOR PLAN
 SCALE: 1/4" = 1'-0"
 NOTES:
 WALL TYPES SEE A2.3
 DOOR SCHEDULE SEE A2.3